



2025 30th ANNUAL LADY GRIZZLY VOLLEYBALL INVITATIONAL

Welcome to the **30th Annual Lady Grizzlies Volleyball Invitational**. We are excited that you are a part of this event and pray your weekend with us will be wonderful.

Each team has been provided with a room to be used during the tournament days. These rooms will be available after **2:00PM on Friday**. Teams will need to stay in the gymnasiums. A key will be issued to you, for your team. All keys must be returned at the end of the tournament. Please give to Paul Salima before you leave on Saturday.

We are starting pool play games at **10:00 am in both gyms South and North Gym. Total of 3 Courts will be used for games. North Gym, South Court 1 and South Court 2 There will be no coaches meeting.** All tournament information including the pool play schedule and tournament brackets will also be in your team packet that will be given to you upon arrival.

Our school is in session so teams need to be quiet in the hallways and around the classroom until school is done at 1:30pm. Teams will be routed outside of the building between gymnasiums.

Awards will follow immediately after the Championship games.

Your team will be responsible for providing a line judge during your pool play time as well as the first games of tournament play. This can be a player or coach. Grace C/JV team players will score all games except Championship Games.

Hospitality room for Coaches is located in the High School Library. This is only for the coaches and officials not your team members.

A full concession will be open throughout the tournament. We will have Food Trucks on-site. In addition, we have a College Fair with 18 Colleges here for your athletes to check out. We will have tournament apparel for sale as well. Team members need to have their passes with them at all times to enter the gym.

Looking forward to hosting your teams!

Paul Salima, Athletic Director





Information Guide



Tournament Dates: Oct 10th & 11th, 2025

Cost: \$275.00- Pay online here: [Team Fee](#) or scan code

or make checks payable to Grace Christian School please mail or bring to tournament.

Please [use these links for Team Rosters](#) and for [Team Photos](#)

ASAP and no later than Friday Oct. 3rd.

Pool Play starts Friday Oct 10th at 10:00am in South and North Gyms

Pool Play/Tournament Play:

Pool Play matches will be played on Friday and continue to Saturday. These matches will be one (1) set to 25 points win by 1, with a 25 min time limit with warm-ups. Warm-ups 2 minutes each and 1 minute shared serves for a total of 5 minutes. When the time is up, next point wins. No timeouts shall occur in the last 2 minutes of the game. Games will start every 35 minutes.

Saturday will be 3 Brackets Platinum, Gold and Silver Double elimination bracket playing 2 out of 3 sets to 20 points win by 2 (3rd set to 15) or 45 minute game cap win by 1 (except Championship games). Warmups 5 minutes. 5 minute transition time. Game starts every 50 minutes. No timeouts shall occur in the last 2 minutes of the game. Games will start every 35 minutes.



The Tournament schedule can be viewed by going to this link [Tournament Schedule](#) or scan. Pool play and the bracket play will be updated as games end so parents will be able to view results in real time.

Line Judges:

Each team shall supply one (1) line judge for their own side during the game that their team plays. This line judge may be a coach, manager, player, parent, etc. If this is a coach, the coach may verbally talk/coach their team, but not until the dead ball whistle.

Score keepers and libero trackers will be provided.

Tie Breaker:

Tie breakers for seeding from Pool Play will be: Head to Head, Average Point Differential, and then Average Points Against. This is done by the automatically by the Quickscores program and is final.

Warm ups:

Pool play and Bracket Play warm-ups will be 2 minutes home team, 2 minutes away team with 1 minute shared with 5 minutes transition time. Home team is the team designated on the top of the schedule.

***Please do not let your teams warm up with the volleyballs in the lobbies as there are breakable items and could present a safety hazard.**

Coaches Meeting:

There will be no coaches meeting as teams have different start times. You will know your start times, opponents and game locations by utilizing the [Tournament Schedule](#) You must pickup your packet either at the gate or front office.

Housing:

We cannot house at this time, however we have Anchorage Christian School that can house and Brandy Woody is the contact at: bwoody@mcc.academy John Warren at Lumen Christi at: athletics@lumenchristiak.com. If either of those options don't work please let Paul Salima know.

Team Rooms:

Each team will be provided a classroom for a changing area. This room should remain locked when no players or coaches are present. Keys along with tournament packet will be given to the Head Coach of each team prior to their first game on Friday. School will still be in session until 1:15 pm, team rooms will be available after 2:00 pm.

AGAIN THIS YEAR:

- **3 Tournament Brackets Double Elimination in Platinum, Gold, and Silver**
- **Lucky Wishbone and Crepe De Paris Food Trucks will be on-site for your teams looking for meals.**
- **College Fair on Friday with 13 different colleges for your teams to check out.**



All Games in both gyms will be LIVESTREAMED at : <https://www.gracechristianalaska.org/live-stream/> and our Facebook Live Page <https://www.facebook.com/GraceChristianAK/>.

Awards:

Trophies will be awarded to the top three teams from each bracket.

All-Tournament Team:

27 players will be awarded All-Tournament team honors. Coaches, please select players **not from your team**. Do not vote for your own players. 9 players will be named from the 1st place teams in each bracket, 6 players from the 2nd place teams in each brackets, and 1 from each of the remaining teams.

“Most Valuable Setter”, “Most Valuable Defensive Player”, and “Most Valuable Offensive Player” will be awarded to any player in the Tournament with the highest number of votes regardless of team’s place. **We will be using this link [ALL TOURNAMENT VOTING ONLINE FORM](#) also as a convenient way for coaches to vote**

Coaches do not vote for your own players.



Hospitality Room:

There will be a hospitality room provided for coaches and officials. This is in the library on the second floor above the South lobby. We will be providing Coaches Lunch and Dinner on Friday, Breakfast and Lunch on Saturday. Always feel free to visit our Cup of Grace and the Food Trucks Outside.

Tournament Gear:

There will be Tournament T-shirts, Hoodies and Various Apparel available for sale.

Equipment:

Please bring your own med kits and volleyballs.

Athletic Trainer: Dr. Matt Dow from Alaska Orthopedic Specialists on site during the tournament.

Gate Fees:

Students and Senior Citizens:\$5 Adults:\$8 Two Day Passes: \$15

Contact Numbers:

Athletic Director: Paul Salima (907) 952-6683 psalima@gracechristianalaska.org



2025 30th Annual Lady Grizzly Tournament Room Assignment

Coaches,

Please keep track of your room key and turn it in to Paul Salima before you depart. Please make sure that you keep your assigned room locked when not occupied and to leave it as you found it. **Very important that the rooms are left as they were and making sure your players do not touch any items on our teacher's desks and drawers.**

Classrooms are located in 1st and 2nd Floor

#144 Bartlett High School	#213 Valdez High School
#111 East High School	#215 Colony High School
#115 Bethel High School	#216 Kenai High School
#116 Kodiak High School	#243 Sitka High School
#143 Monroe Catholic High School	#210 Soldotna High School
#212 Houston High School	#245 Su-Valley High School
#148 Mt. Edgecumbe School	#246 Seward High School
#108 Nikiski High School	#247 Homer High School
#152 Grace Christian School	#248 Mountain City Christian Academy
#150 JV Grace Christian School	

Please note that these room assignments can change before tournament date.

ROOMS AVAILABLE AFTER 2PM ON FRIDAY



Busses and Oversize Vehicle Parking



PARKING AREA

Anchorage Grace Church

2407 Pintail St

Asian Bible Church

Grace Christian School

PARKING AREA

PARKING AREA ONLY AFTER 2PM FRIDAY

FOOD TRUCKS

PARKING AREA

PARKING AREA

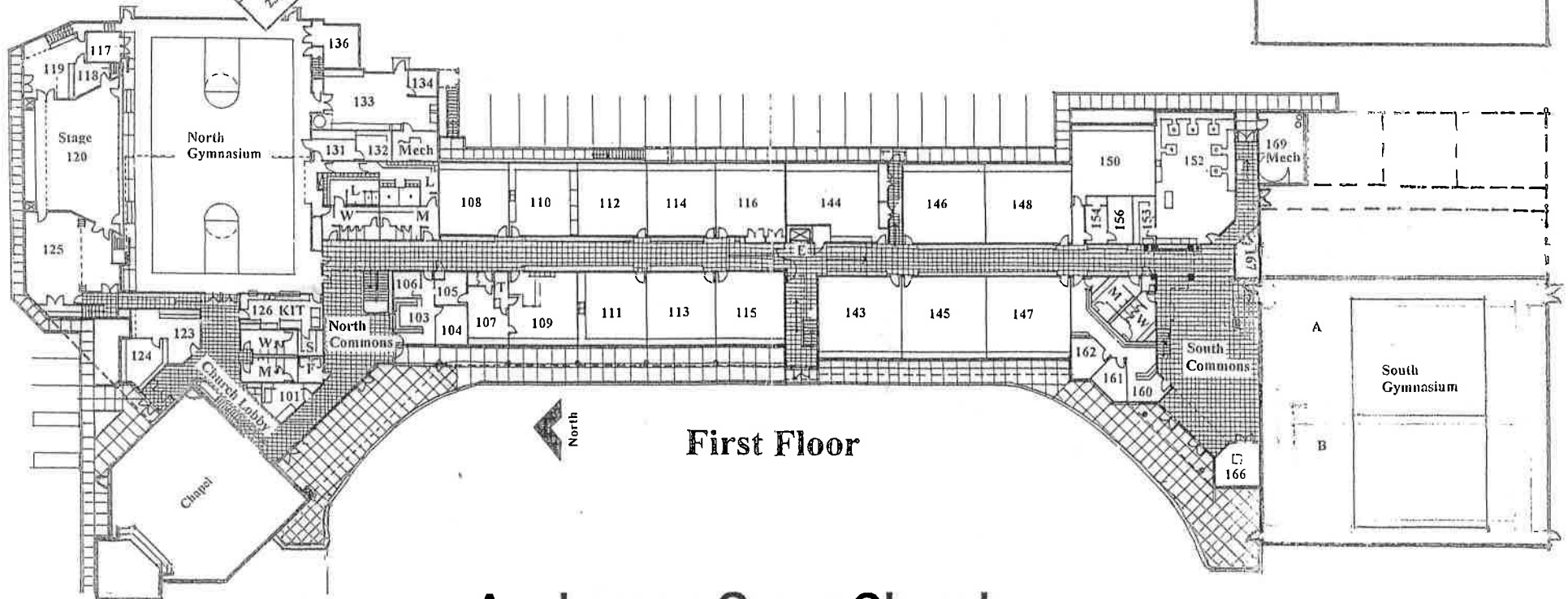
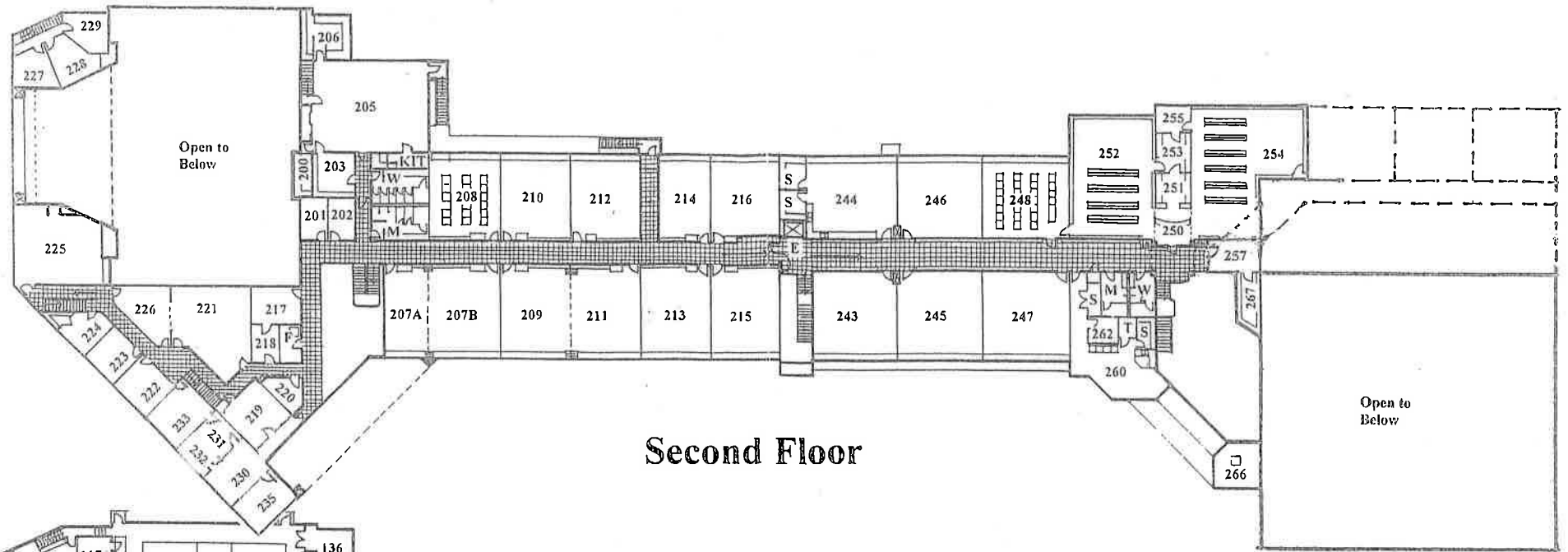

**Anchorage Grace Church
Grace Christian School**